



40-Volt Cordless Leaf Blower

H40CF900HE / H40CF900ES

OPERATOR'S MANUAL

Original instructions

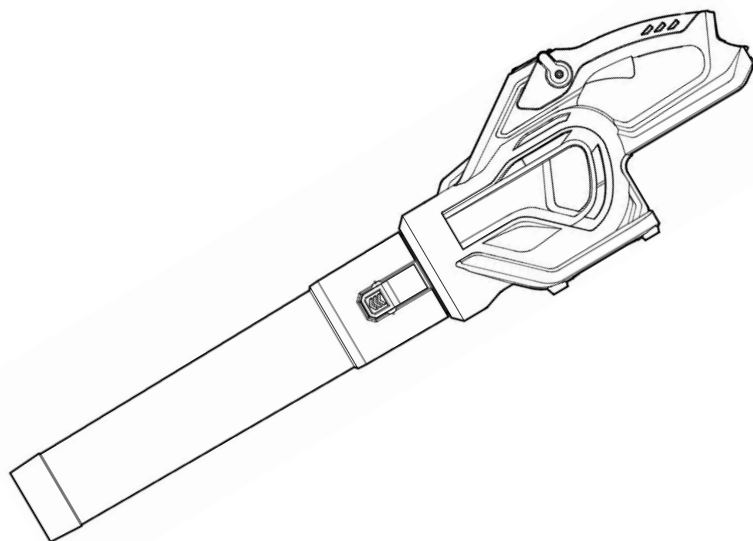

WARNING: Read all safety rules and instructions carefully before operating this tool. Improper use can cause serious or fatal injury.



TABLE OF CONTENTS

Safety Symbols.....4

Important Safety Instructions..... 5-14

Specifications..... 15-16

Assembly..... 17-18

Description..... 19

Operation.....20-23

Maintenance..... 24

Troubleshooting..... 25

Warranty..... 26-27

Parts List.....28

IMPORTANT

READ CAREFULLY BEFORE USE.

KEEP FOR FUTURE REFERENCE



read operator's manual

⚠ WARNING: Some dust created by power sanding, sawing, grinding, drilling and other construction activities contains chemicals known to the state of California to cause cancer, birth defects or other reproductive harm. Some examples of these chemicals are:

Lead from lead-based paints,

Crystalline silica from bricks and cement and other masonry products, and

Arsenic and chromium from chemically-treated lumber.

Your risk from these exposures varies, depending on how often you do this type of work. To reduce your exposure to these chemical: work in a well ventilated area, and work with approved safety equipment, such as those dust masks that are specially designed to filter out microscopic particles.

SAFETY GUIDELINES

SAFETY SYMBOLS

The purpose of safety symbols is to attract your attention to possible dangers. The safety symbols and the explanations with them deserve your careful attention and understanding. The symbol warnings do not, by themselves, eliminate any danger. The instructions and warnings they give are no substitutes for proper accident prevention measures.

⚠ WARNING: Be sure to read and understand all safety instructions in this Operator's Manual, including all safety alert symbols such as "**DANGER**," "**WARNING**," and "**CAUTION**" before using this tool. Failure to following all instructions listed below may result in electric shock, fire, and/or serious personal injury.

DAMAGE PREVENTION AND INFORMATION MESSAGES

These inform the user of important information and/or instructions that could lead to equipment or other property damage if they are not followed. Each message is preceded by the word "NOTICE", as in the example below:





NOTICE: Equipment and/or property damage may result if these instructions are not followed.







⚠ WARNING: The operation of any power tools can result in foreign objects being thrown into your eyes, which can result in severe eye damage. Before beginning power tool operation, always wear safety goggles or safety glasses with side shields and a full face shield when needed. We recommend a Wide Vision Safety Mask for use over eyeglasses or standard safety glasses with side shields. Always use eye protection.

IMPORTANT SAFETY INSTRUCTIONS

This page depicts and describes safety symbols that may appear on this product. Read, understand, and follow all instructions on the machine before attempting to assemble and operate.

| | | |
|---|------------------------|--|
|  | Safety Alert | Precautions that involve your safety. |
|  | Read Operator's Manual | To reduce the risk of injury, user must read and understand operator's manual before using this product. |
|  | Long Hair | Failure to keep long hair away from the air inlet could result in personal injury. |
|  | Loose Clothing | Failure to keep loose clothing from being drawn into air intake vents could result in personal injury. |
|  | Eye Protection | Always wear safety goggles or safety glasses with side shields and a full face shield when operating this product. |

| | | |
|--|---------------------------------|---|
|  | Blower Tube | Do not operate without tube in place. |
|  | Do not expose to rain | Do not expose to rain |
|  | Keep Bystanders Away | Keep all bystanders at least 50 ft. away. |
|  | Recycle Symbols | This product uses lithium-ion (Li-ion) batteries. Local, state, or federal laws may prohibit disposal of batteries in ordinary trash. Consult your local waste authority for information regarding available recycling and/or disposal options. |
|  | Charging/Store the battery pack | Charging and Store the battery pack only in dry rooms with an ambient temperature of 50°F to 104°F (+10°C to +40°C). |
| V | Volt | Voltage |
| A | Amperes | Current |
| Hz | Hertz | Frequency (cycles per second) |
| W | Watt | Power |

| | | |
|----------------|-----------------------|---|
| min | Minutes | Time |
| CFM | Cubic Feet Per Minute | Air volume |
| MPH | Miles Per Hour | Air velocity |
| ~ | Alternating Current | Type of current |
| ≡ | Direct Current | Type or a characteristic of current |
| n ₀ | No Load Speed | Rotational speed, at no load |
| ... /min | Per Minute | Revolutions, strokes, surface speed, orbits, etc., per minute |

When using an electrical appliance, basic precautions should always be followed, including the following:

IMPORTANT SAFETY INSTRUCTIONS

READ ALL INSTRUCTIONS

BEFORE USING (THIS APPLIANCE)

⚠ WARNING – To reduce the risk of fire, electric shock, or injury:

- a) Do not leave appliance when fitted with battery pack. Remove battery pack from machine when not in use and before servicing.
- b) Do not use outdoors or on wet surfaces.
- c) Do not allow to be used as a toy. Close attention is necessary when used by or near children.
- d) Use only as described in this manual. Use only manufacturer's recommended attachments.
- e) Do not use with damaged battery pack. If appliance is not working as it should, has been dropped, damaged, left outdoors, or dropped into water, return it to a service center.
- i) Do not put any object into openings. Do not use with any opening blocked; keep free of dust, lint, hair, and anything that may reduce air flow.
- j) Keep hair, loose clothing, fingers, and all parts of body away from openings and moving parts.
- k) Turn off all controls before removing battery pack.
- l) Use extra care when cleaning on stairs.
- m) Do not use to pick up flammable or combustible liquids, such as gasoline, or use in areas where they may be present.

SAVE THESE INSTRUCTIONS

Charging battery pack only in dry conditions and an ambient temperature of 50°F to 104°F (10°C to 40°C). Protect them from humidity and direct sunlight!

Store the charger, battery pack and machine only in dry places with an ambient temperature of 50°F to 104°F (10°C to 40°C).

READ ALL INSTRUCTIONS BEFORE USING THIS PRODUCT!

 **WARNING** – To reduce the risk of injury, user must read instruction manual.

 **WARNING** – Read all safety warnings and instructions. Failure to follow the warnings, and instructions may result in electric shock, fire and/ or serious injury.

- **Prevent unintentional starting.** Ensure the power switch is in the off-position before connecting to battery pack, picking up or carrying the appliances. Carrying the appliances with your finger on the power switch, or energizing appliances that have the switch on, invites accidents.
- **Make sure the power switch is off and the battery pack is removed before clearing jammed material, making adjustments, changing accessories, storing or servicing the appliance. Unexpected actuation of the appliance while clearing jammed material or servicing may result in serious personal injury.**
- **Recharge only with the charger specified by the manufacturer.** A charger that is suitable for one type of battery pack may create a risk of fire when used with another battery pack.
- **Use appliance only with specifically designated battery packs.** Use of any other battery packs may create a risk of injury and fire.
- **When battery pack is not in use, keep it away from other metal objects, like paper clips, coins, keys, nails, screws or other small metal objects that can make a connection from one terminal to another.** Shorting the battery terminals together may cause burns or fire.
- **Under abusive conditions, liquid may be ejected from the battery; avoid contact.** If contact accidentally occurs, flush with water. If liquid contacts eyes, additionally seek medical help. Liquid ejected from the battery may cause irritation or burns.
- **Do not use a battery pack or appliance that is damaged or modified.** Damaged or modified batteries may exhibit unpredictable behavior resulting in fire, explosion or risk of injury.
- **Do not expose a battery pack or appliance to fire or excessive temperature.** Exposure to fire or temperature of 130°C can be replaced by the temperature of 265°F.

- **Follow all charging instructions and do not charge the battery pack or appliance outside of the temperature range specified in the instructions.** Charging improperly or at temperatures outside of the specified range may damage the battery and increase the risk of fire.
- **Have servicing performed by a qualified repair person using only identical replacement parts.** This will ensure that the safety of the product is maintained.
- **Do not modify or attempt to repair the appliance or the battery packs(as applicable) except as indicated in the instructions use and care.**

⚠ DANGER: People with electronic devices, such as pacemakers, should consult their physician(s) before using this product. Operation of electrical equipment in close proximity to a heart pacemaker could cause interference or failure of the pacemaker.

⚠ WARNING: To ensure safety and reliability, all repairs should be performed by a qualified service technician.

⚠ WARNING: To reduce the risk of fire, electric shock, or injury:

Know your power blower. Read the instruction manual carefully. Learn the blower's applications and limitations, as well as the specific potential hazards related to this blower. Following this rule will reduce the risk of electric shock, fire, or serious injury.

Do not allow the blower to be used as a toy. Close attention is necessary when used by or near children.

Use only as described in this manual. Use only manufacturer's recommended attachments.

Do not use with damaged cord or plug. If appliance is not working as it should, has been dropped, damaged, left outdoors, or dropped into water, return it to a service center.

Do not handle plug or appliance with wet hands.

Do not put any object into openings. Do not use with any opening blocked; keep free of dust, lint, hair, and anything that may reduce air flow.

Keep hair, loose clothing, fingers, and all parts of body away from openings and moving parts..

Secure long hair above shoulder level to prevent entanglement in moving parts.

Use extra care when cleaning on stairs.

Battery Tool Use And Care

Recharge only with the charger specified by the manufacturer. A charger that is suitable for one type of battery pack may create a risk of fire when used with another battery pack.

Use the battery operated blowers only with specifically designated battery packs. Use of any other battery packs may create a risk of injury and fire.

When battery pack is not in use, keep it away from other metal objects, like paper clips, coins, keys, nails, screws or other small metal objects that can make a connection from one terminal to another. shorting the battery terminals together may cause burns or a fire.

Under abusive conditions, liquid may be ejected from the battery; avoid contact. If contact accidentally occurs, flush with water. if liquid contact eyes, additionally seek medical help. Liquid ejected from the battery may cause irritation or burns.

Battery powered leaf blowers do not have to be plugged into an electrical outlet; therefore, they are always in operating condition. Be aware of possible hazards when not using your battery powered hedge trimmer or when changing accessories. Following this rule will reduce the risk of electric shock, fire, or serious personal injury.

Do not charge the battery pack outdoors.

Use only the charger supplied by the manufacturer to recharge.

Do not leave blowers unattended when the battery is inserted. Remove the battery when the blower is not in use and before servicing.

Do not use to pick up flammable or combustible liquids, such as gasoline, or use in areas where they may be present.

Do not operate blowers in explosive atmospheres, such as in the presence of

flammable liquids, gases, or dust. Blowers create sparks which may ignite the dust or fumes.

Use only with battery packs and chargers listed below.

| BATTERY PACK | CHARGER |
|----------------------------------|--------------------------------------|
| H40B25,H40B50, H40B75,H40B200 | H40KC400 H40MC100(XVE129-4200300) |

Stay alert, watch what you are doing and use common sense when operating a power blower. Do not use the blower while tired, upset, or under the influence of drugs, alcohol, or medication. A moment of inattention while operating blowers may result in serious personal injury.

Avoid accidental starting. Be sure that the switch is in the locked or off position before inserting the battery pack. Carrying blowers with your finger on the switch or inserting the battery pack into a blower with the switch on invites accidents.

Use safety equipment. Always wear eye protection. Dust mask, non-skid safety shoes, hard hat, or hearing protection must be used for appropriate conditions.

Do not use on a ladder, rooftop, tree, or other unstable support. Stable footing on a solid surface enables better control of the blower in unexpected situations. Always take care of your feet, children, or pets around you when removing the battery pack from blower. **Serious injury could result if the battery pack falls.**

Do not use the blower if switch does not turn it on or off. A blower that cannot be controlled with the switch is dangerous and must be repaired.

Disconnect the battery pack from the blower before making any adjustments, changing accessories, or storing the blower. Such preventive safety measures reduce the risk of starting the blower accidentally.

Turn off all controls before removing the battery.

DO NOT attempt to clear clogs from the unit without first removing the battery.

Check for misalignment or binding of moving parts, breakage of parts, and any other condition that may affect the blower's operation. If damaged, have the blower serviced before using. Many accidents are caused by poorly maintained blowers.

Keep the blower and its handle dry, clean and free from oil and grease. Always use a clean cloth when cleaning. Never use brake fluids, gasoline, petroleum-based products, or any strong solvents to clean your blower. Following this rule will reduce

the risk of loss of control and deterioration of the enclosure plastic.

Always wear safety glasses with side shields. Everyday glasses have only impact resistant lenses. They are NOT safety glasses. Following this rule will reduce the risk of eye injury.

Always wear eye protection with side shields along with hearing protection when operating this equipment.

Protect your lungs. Wear a face or dust mask if the operation is dusty.

Following this rule will reduce the risk of serious personal injury.

Protect your hearing. Wear hearing protection during extended periods of operation. Following this rule will reduce the risk of serious personal injury.

Battery powered blowers do not have to be plugged into an electrical outlet; therefore, they are always in operating condition. Be aware of possible hazards when not using your battery powered blower or when changing accessories. Following this rule will reduce the risk of electric shock, fire, or serious personal injury.

Wear heavy long pants, long sleeves, boots, and gloves. Avoid loose garments or jewelry that could get caught in moving parts of the machine or its motor.

Do not operate the equipment while barefoot or when wearing sandals or similar lightweight footwear. Wear protective footwear that will protect your feet and improve your footing on slippery surfaces.

Do not incinerate the appliance even if it is severely damaged. The batteries can explode in a fire.

Batteries can explode in the presence of a source of ignition, such as a pilot light. To reduce the risk of serious personal injury, never use any cordless product in the presence of open flame. An exploded battery can propel debris and chemicals. If exposed, flush with water immediately.

Keep firm footing and balance. Do not overreach. Overreaching can result in loss of balance.

Check the work area before each use. Remove all objects such as rocks, broken glass, nails, wire, or string which can be thrown by or become entangled in the machine.

Do not point the blower tube in the direction of people or pets.

Never run the unit without the proper equipment attached. Always ensure that the blower tube is installed.

When not in use, the blower should be stored indoors in a dry, secure place out of the reach of children.

Keep all bystanders, children, and pets at least 50 ft. away.

Blower service must be performed only by qualified repair personnel. Service or maintenance performed by unqualified personnel may result in a risk of injury.

When servicing a blower, use only identical replacement parts. Follow instructions in the Maintenance section of this manual. Use of unauthorized parts or failure to follow Maintenance Instructions may create a risk of shock or injury.

Never use the blower near fires or hot ashes. Use near fires or ashes can spread fires and result in serious injury and/or property damage.

Never use blower to spread chemicals, fertilizers, or any other toxic substances. Spreading these substances could result in serious injury to the operator or bystanders.

Never place the blower on any surface, except a hard, clean surface when the engine is running. Gravel, sand, and other debris can be picked up by the air inlet and thrown at the operator or bystanders, causing possible serious injuries.

Save these instructions. Refer to them frequently and use them to instruct others who may use this tool. If you loan this tool to someone else, also loan these instructions to them to prevent misuse of the product and possible injury.

SAVE THESE INSTRUCTIONS!

intended use

This tool is used to blow away dust leaves.

SPECIFICATIONS

| | | |
|---|---|---|
| Model | H40CF900HE | H40CF900ES |
| Voltage | 40V DC | 40V DC |
| No Load Speed | Boost: 25000 RPM | Boost: 25000 RPM |
| | High:22000 RPM | High:18000 RPM |
| | Low:18000 RPM | Low:10000 RPM |
| Air Volume | Boost: 530CFM | Boost: 530CFM |
| | High: 442 CFM | High: 353CFM |
| | Low: 353 CFM | Low: 170 CFM |
| Air Velocity | Boost: 107 MPH | Boost: 107 MPH |
| | High: 90 MPH | High: 72 MPH |
| | Low: 72 MPH | Low: 36 MPH |
| Approx. Run Time | 4 min.(1P1)(Boost) 12min (2P1)(Boost) 18min(3P1)(Boost) | 4min.(1P1)(Boost) 12min (2P1)(Boost) 18min(3P1)(Boost) |
| | 7min. (1P1)(High speed) 19min.(2P1)(High speed) 28min.(3P1)(High speed) | 13min. (1P1)(High speed) 32min(2P1)(High speed) 46min.(3P1)(High speed) |
| | 15 min. (1P1)(Low speed) 33min(2P1)(Low speed) 47min(3P1)(Low speed) | 68min.(1P1) (Low speed) 147min.(2P1)(Low speed) 210min.(3P1)(Low speed) |
| Blower Weight (Without battery pack, with tube) | 4.6 lb. (2.1 kg) | 4.6 lb. (2.1 kg) |

| | | | | |
|------------------------------------|---------------------------------|--------|--------|---------|
| Battery pack | Lithium-Ion | | | |
| Models | H40B75 | H40B50 | H40B25 | H40B200 |
| voltage | 40 VDC | 40 VDC | 40 VDC | 40 VDC |
| Capacity | 7.5Ah | 5.0Ah | 2.5Ah | 20Ah |
| Charger (model) | H40KC400 | | | |
| Input | 120VAC 60Hz, 400W | | | |
| Output | 40 VDC, 8A | | | |
| Allowable charge temperature range | 0 - 40 °C | | | |
| Charger (model) | H36MC100(XVE129-4200300) | | | |
| Input | 100-120 VAC, 50/60Hz, 2.5A Max; | | | |
| Output | 42.0VDC, 3A | | | |
| Allowable charge temperature range | 0 - 40 °C | | | |

ASSEMBLY

⚠ WARNING: If any parts are damaged or missing, do not operate this product until the parts are replaced. Use of this product with damaged or missing parts could result in serious personal injury.

⚠ WARNING: Do not attempt to modify this product or create accessories not recommended for use with this blower. Any such alteration or modification is misuse and could result in a hazardous condition leading to possible serious personal injury.

UNPACKING

Carefully remove the product and any accessories from the box. Make sure that all items listed in the packing list are included.

⚠ WARNING: Do not use this product if any parts on the packing list are already assembled to your product when you unpack it. Parts on this list are not assembled to the product by the manufacturer and require customer installation. Use of a product that may have been improperly assembled could result in serious personal injury.

Inspect the tool carefully to make sure no breakage or damage occurred during shipping.

Do not discard the packing material until you have carefully inspected and satisfactorily operated the tool.

If any parts are damaged or missing, please return the product to the place of purchase.

LIST OF PARTS

| PART NAME | QUANTITY |
|-------------------|----------|
| Blower | 1 |
| Blower tube | 1 |
| Operator's manual | 1 |

ASSEMBLING THE BLOWER TUBE

⚠ WARNING: To prevent accidental starting that could cause serious personal injury, always remove the battery pack from the tool when assembling parts.

1. Align the groove in the tube with the knob on the blower housing. Push the tube onto the blower housing until the latch snaps into place (Fig. 1 & 2).
2. To remove the tube, press and hold the tube-release button to disengage the latch, then pull the tube straight from the blower (Fig. 3).

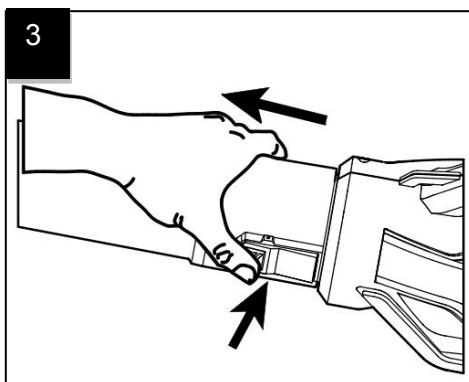
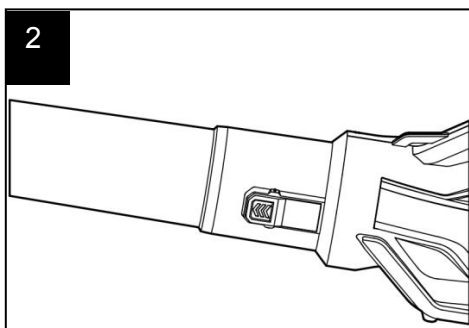
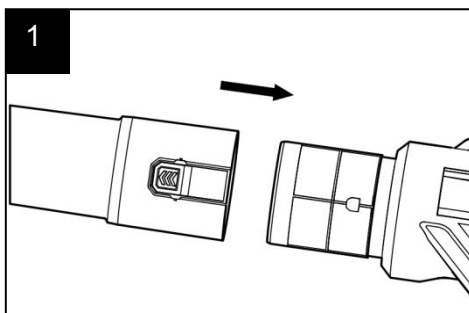

DESCRIPTION

KNOW YOUR BLOWER (Fig. 4)

The safe use of this product requires and understanding of the information on the tool and in this instruction manual as well as knowledge of the project you are attempting. Before use of this product, familiarize yourself with all operating features and safety rules.

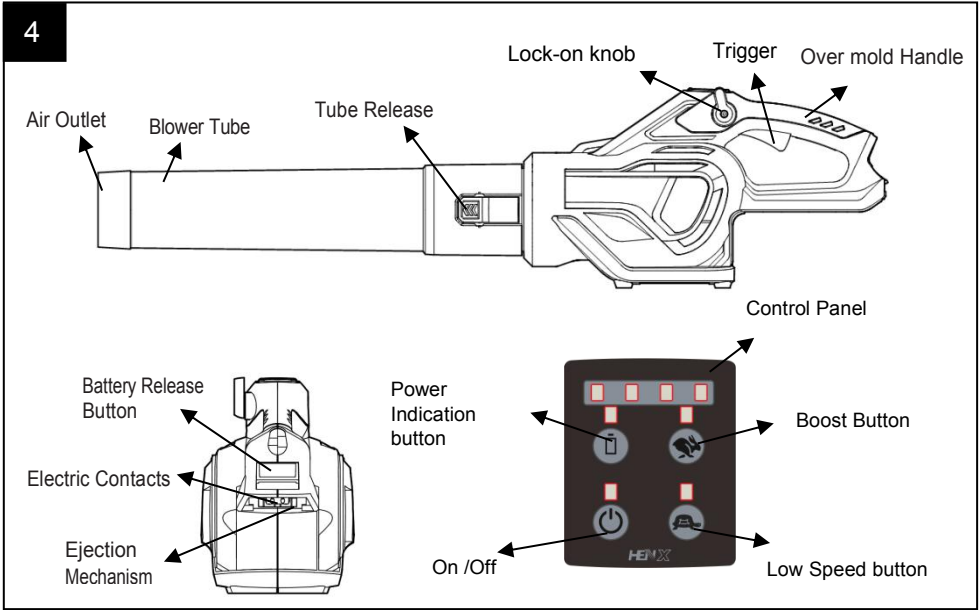

| | |
|------------------------|---|
| Control Panel | Power Indicator, On/Off control, Speed control |
| Trigger | Starts or stops the blower |
| Lock-on knob | Lock the speed on without keeping fingers on the trigger when operating |
| Battery-Release Button | Releases the battery pack from the blower. |
| Over mold Handle | Ergonomic handle with overmold improves comfort and grip. |

OPERATION

⚠ WARNING: Do not allow familiarity with this product to make you careless. Remember that a careless fraction of a second is sufficient to inflict serious injury.

⚠ WARNING: Always wear eye protection with side shields, along with hearing protection. Failure to do so could result in objects being thrown into your eyes and other possible serious injuries.

⚠ WARNING: Do not use any attachments or accessories not recommended by the manufacturer of this product. The use of attachments or accessories not recommended can result in serious personal injury.

Before each use, inspect the entire product for damaged, missing, or loose parts, such as screws, nuts, bolts, caps, etc. Tighten securely all fasteners and caps and do not operate this product until all missing or damaged parts are replaced.

APPLICATION

You may use this product for the purposes listed below:

Clearing hard surfaces such as driveways and walkways

Keeping decks and driveways free from leaves and pine needles

TO INSTALL/REMOVE BATTERY PACK (Fig. 5)

CHARGE BEFORE FIRST USE.

⚠ WARNING: Always remove the battery pack from the product when you are assembling parts, making adjustments, cleaning, or when not in use. Removing the battery pack will prevent accidental starting that could cause serious personal injury.

TO INSTALL

Align the ribs of the battery pack with the mounting slots in the blower's battery port.

Press the battery pack down until it snaps into position.

TO REMOVE

⚠ WARNING: Always take care to note the location of your feet, children, or pets when pressing the battery-release button. Serious injury could result if the battery pack falls.

Press the battery-release button; the battery pack will disengage from the latch and the ejection mechanism will assist with removal.

Remove the battery pack from the blower.

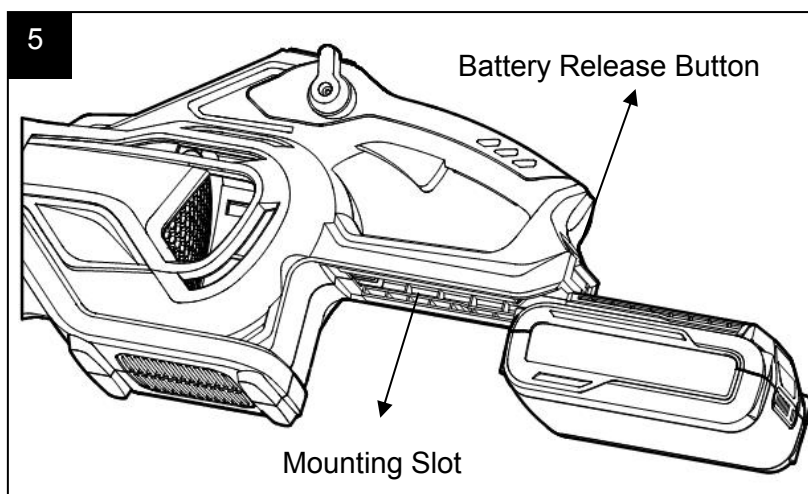

STARTING/STOPPING THE BLOWER (Fig. 6)

To start the blower, press power on button, then press the trigger.

The blower will begin to run.

To stop the blower, release the trigger, press power off.

ADJUSTING THE AIR VELOCITY (Fig. 6)

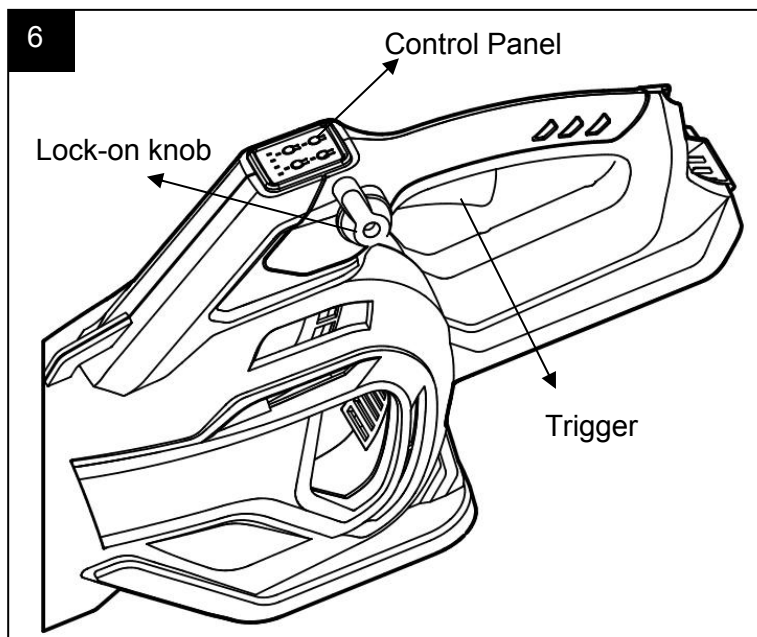

The blower is equipped with stepless speed regulation to control the air speed.

The lock-on knob rotates clockwise to adjust the wind speed and free your finger from the trigger.

The blower starts with High speed, can switch the speed by pressing the speed button.

Boost speed mode last for 10 seconds, then the wind volume will return to the previous high or low speed.

Power indicator shows the balance power of the battery.

OPERATING THE BLOWER

To keep from scattering debris, blow around the outer edges of a debris pile.

Never blow directly into the center of a pile.

To reduce sound levels, limit the number of pieces of equipment used at any one time.

Use rakes and brooms to loosen debris before blowing. In dusty conditions, slightly dampen surfaces if water is available.

Conserve water by using power blowers instead of hoses for many lawn and garden applications, including areas such as gutters, screens, patios, grills, porches, and gardens.

Watch out for children, pets, open windows, or freshly washed cars, and blow debris safely away.

After using blowers or other equipment, clean up! Dispose of debris properly.

MAINTENANCE

⚠ WARNING: When servicing, use only identical replacement parts. Use of any other parts may create a hazard or cause product damage. To ensure safety and reliability, all repairs should be performed by a qualified service technician.

⚠ WARNING: To avoid serious personal injury, always remove the battery pack from the product when cleaning or performing any maintenance.

GENERAL MAINTENANCE

Avoid using solvents when cleaning plastic parts. Most plastics are susceptible to damage from various types of commercial solvents and may be damaged by their use. Use clean clothes to remove dirt, dust, oil, grease, etc.

⚠ WARNING: Do not at any time let brake fluids, gasoline, petroleum-based products, penetrating oils, etc., come in contact with plastic parts. Chemicals can damage, weaken or destroy plastic which may result in serious personal injury.

STORAGE

Clean all foreign material from the air inlets of the blower.

Store indoors in a place that is inaccessible to children. Keep away from corrosive agents, such as garden chemicals and deicing salts.

TROUBLESHOOTING

| PROBLEM | CAUSE | SOLUTION |
|---------------------------------------|--|--|
| Blower doesn't work. | <ul style="list-style-type: none"> ● The battery pack is not attached to the blower. ● No electrical contact between the blower and battery ● The battery pack is depleted. ● The battery pack or blower is too hot. | <ul style="list-style-type: none"> ● Attach the battery pack to the blower. ● Remove battery, check contacts and reinstall the battery pack. ● Charge the battery pack. ● Cool the battery pack and blower until the temperature drops below 152°F (67°C). |
| The air velocity decreases obviously. | <ul style="list-style-type: none"> ● Excessive wearing of motor fan. ● The air inlet is blocked by debris. | <ul style="list-style-type: none"> ● Contact HENX service center for repair. ● Remove the battery pack, clear the debris. |

WARRANTY

HENX WARRANTY POLICY

4 year limited warranty on HENX outdoor power equipment and 2 year limited warranty on HENX battery packs and chargers.

Please contact HENX Customer Service Toll-Free at 86-574-62037812 any time you have questions or warranty claims.

LIMITED SERVICE WARRANTY

FOR FOUR YEARS from the date of original retail purchase, this HENX product is warranted against defects in material or workmanship. Defective product will receive free repair.

FOR TWO YEARS from the date of original retail purchase, the HENX ONE System battery pack and charger are warranted against defects in material or workmanship. Defective product will receive free repair.

- a. This warranty does not cover routine maintenance parts and consumables that can wear out from normal use within the warranty period.
- b. This warranty applies only to the original purchaser from an authorized HENX retailer and may not be transferred.
- c. The warranty period for any HENX product or part used for industrial, professional or commercial purpose is ONE year.
- d. This warranty is void if the product has been used for rental purpose.
- e. This warranty does not cover the damage resulting from modification, alteration or unauthorized repair.
- f. This warranty only covers defects arising under normal usage and does not cover any malfunction, failure or defect resulting from misuse, abuse (including overloading of the product beyond capacity and immersion in water or other liquid), accidents, neglect or lack of proper installation, and improper maintenance or storage.
- g. This warranty does not cover normal deterioration of the exterior finish, including but not limited to scratches, dents, paint chips, or to any corrosion or discoloring by heat, abrasive and chemical cleaners.

HOW TO OBTAIN SERVICE

For warranty service, please contact HENX customer service at

86-574-62037812. When requesting warranty service, you must present the original dated sales receipt. An authorized service center will be selected to repair the product according to the stated warranty terms.

ADDITIONAL LIMITATIONS

To the extent permitted by applicable law, all implied warranties, including warranties of MERCHANTABILITY or FITNESS FOR A PARTICULAR PURPOSE, are disclaimed. Any implied warranties, including warranties of merchantability or fitness for a particular purpose, that cannot be disclaimed under state law are limited to three years from the date of purchase for outdoor power equipment and two years from date of purchase for battery pack and charger.

Some states do not allow limitations on how long an implied warranty lasts and/or do not allow the exclusion or limitation of incidental or consequential damages, so the above limitations may not apply to you.

This warranty gives you specific legal rights, and you may also have other rights which vary from state to state.

For customer service contact us at: 86-574-62037812 or www.henxgarden.com HENX customer service.

PARTS LIST

40V LITHIUM-ION CORDLESS BLOWER

The Model Number will be found on the Nameplate attached to the housing of the blower. Always mention the Model Number when ordering parts for this tool.

EXPLODED VIEW

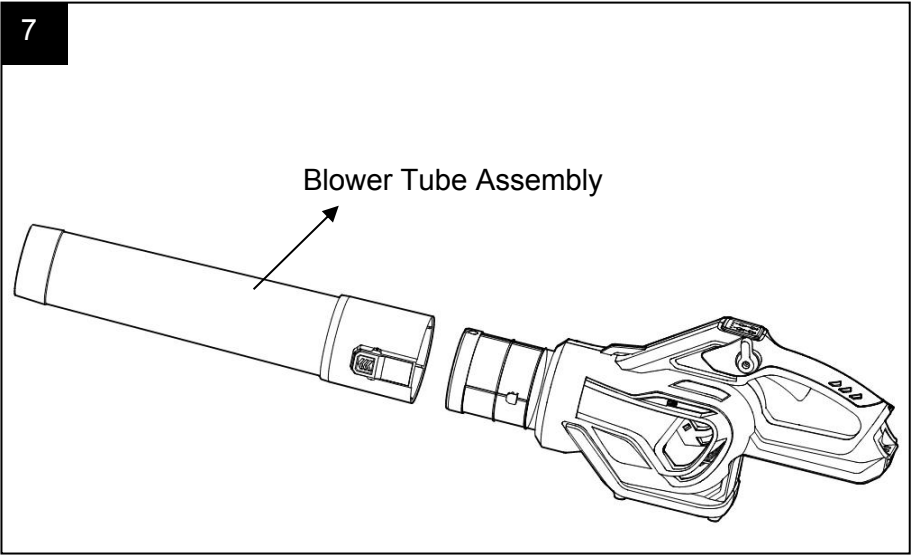

PART LIST

| No. | Part Name | Quantity |
|-----|--------------------|----------|
| 1 | Blow Tube Assembly | 1 |



Bring Power to Your Garden.

www.henxgarden.com